

COMMUNITY CENTER

CLAIRTON, PENNSYLVANIA



THE COMMUNITY ECONOMIC DEVELOPMENT CORPORATION OF CLAIRTON (CEDCC) ENGAGED RED SWING TO PROVIDE SITE CIVIL ENGINEERING/COORDINATION SERVICES TO SUPPORT THE DESIGN AND CONSTRUCTION OF A NEW 3,500-SQUARE-FOOT COMMUNITY CENTER ON A 1/3-ACRE SITE IN THE CITY OF CLAIRTON, PA. SCOPE ITEMS INCLUDED:

- DESIGN AND PREPARATION OF CONSTRUCTION PLANS AND DOCUMENTS.
- COORDINATING WITH THE LOCAL MUNICIPALITY AND PENNDOT FOR PERMITTING/ZONING APPROVALS.
- DEVELOPING EROSION AND SEDIMENTATION CONTROL, AS WELL AS STORMWATER MANAGEMENT, PLANS.
- DESIGNING SITE UTILITIES LAYOUT.
- COORDINATION OF GEOTECHNICAL INVESTIGATIONS
- ON-SITE COORDINATION WITH CONSTRUCTION CONTRACTOR.

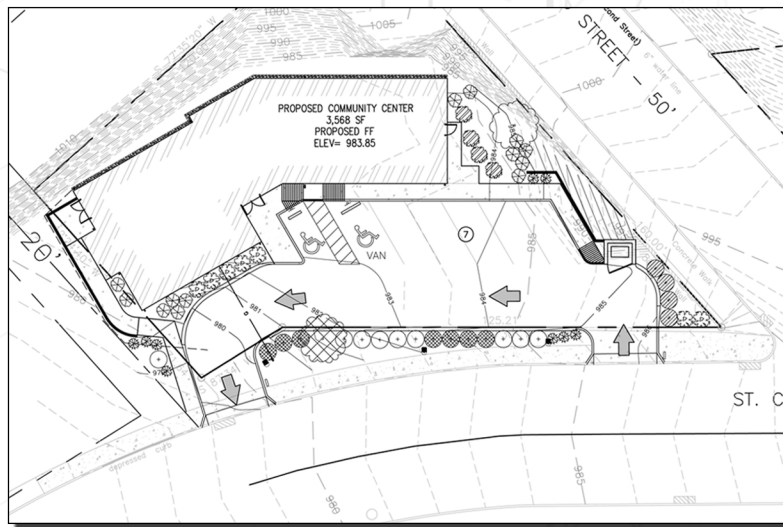

SITE CHALLENGES:

- DRAINAGE ISSUES: TO ADDRESS WATER SEEPAGE FROM A HILL DIRECTLY BEHIND THE NEW COMMUNITY CENTER, RED SWING COORDINATED WITH THE CONSTRUCTION CONTRACTOR TO DETERMINE THE PLACEMENT OF FRENCH DRAINS AND A RAIN GARDEN THAT WOULD DIVERT THE FLOW AWAY FROM THE NEW BUILDING SITE.
- SITE CONSTRAINTS: BECAUSE OF THE SMALL SITE SIZE AND A STEEP ROCK WALL AT THE BACK OF THE PROPERTY, RED SWING WORKED WITH THE ARCHITECT AND GEOTECHNICAL ENGINEER TO EFFECTIVELY DESIGN THE BUILDING FOOTPRINT, DRIVEWAY AND PARKING AREAS TO CONFORM TO THE CONFINES OF THE PROPERTY.

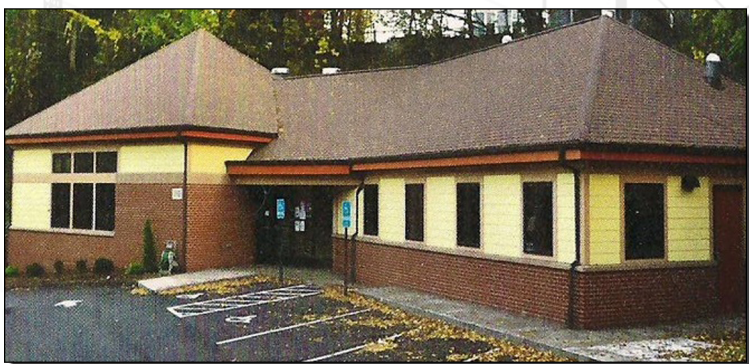

PROJECT DATES:

NOVEMBER 2009 - SEPTEMBER 2011

CLIENT:

COMMUNITY ECONOMIC DEVELOPMENT CORPORATION OF CLAIRTON

KEY PERSONNEL:

MATTHEW SMITH, ROBERT MCCOLLIM

ARCHITECT:

LAMI GRUBB ARCHITECTS

4154 OLD WILLIAM PENN HIGHWAY, SUITE 300 • MURRYSVILLE, PA 15668

P: 724.325.1215 F: 866.295.5226

WWW.REDSWINGGROUP.COM

CIVIL ENGINEERING • DUE DILIGENCE • SUSTAINABLE & WATER • TELECOMMUNICATIONS • OWNERS