

MEMORIAL PARK PRESBYTERIAN CHURCH EXPANSION ALLISON PARK, PENNSYLVANIA



RED SWING GROUP WAS RETAINED BY MEMORIAL PARK PRESBYTERIAN CHURCH TO PROVIDE LAND DEVELOPMENT SERVICES FOR THE PHASED EXPANSION OF THEIR BUILDING AND CAMPUS, PROVIDING CONSTRUCTION PLAN DOCUMENTS AND MUNICIPAL APPROVAL SUPPORT. RED SWING GROUP LED AND/OR MANAGED SEVERAL ASPECTS OF THE PROJECT, INCLUDING:



- PHYSICAL AND TOPOGRAPHICAL SURVEYING FOR AN 11-ACRE PARCEL TO SUPPORT DESIGN AND PERMIT APPROVALS OF LAND DEVELOPMENT ACTIVITIES.
- DRILLING AND GEOTECHNICAL INVESTIGATION SERVICES.
- CIVIL ENGINEERING AND PERMITTING THROUGH FINAL SITE PLAN APPROVAL WITH THE TOWN OF McCANDLESS.
- COORDINATION WITH THE ALLEGHENY COUNTY CONSERVATION DISTRICT (ACCD) FOR EROSION & SEDIMENTATION POLLUTION CONTROL AND NPDES PERMITTING.
- HIGHWAY OCCUPANCY PERMIT (HOP) PROCESS.

SITE CHALLENGES:

- DEFICIENT STORMWATER MANAGEMENT: BECAUSE OF DEFICIENT OUTLET STRUCTURE AND INLET PIPING, THE CURRENT STORMWATER SYSTEM COULD NOT HANDLE ANY ADDITIONAL FLOW. RED SWING RECOMMENDED UPGRADES TO THE EXISTING FACILITY, AS WELL AS DESIGNED A NEW UNDERGROUND STORMWATER DETENTION SYSTEM CAPABLE OF HANDLING FLOW FROM THE EXPANSION.
- PENNDOT RIGHT-OF-WAY (ROW): RED SWING COORDINATED WITH PENNDOT TO SECURE TWO ROW APPROVALS: ONE FOR A SIDEWALK INSTALLATION AND CONNECTION TO AN EXISTING CROSSWALK RAMP AT THE SIGNALIZED INTERSECTION OF PEEBLES ROAD AND DUNCAN AVENUE, AND ONE FOR THE CONNECTION OF THE SW MANAGEMENT SYSTEM TO AN EXISTING INLET ON DUNCAN AVENUE EXTENSION.

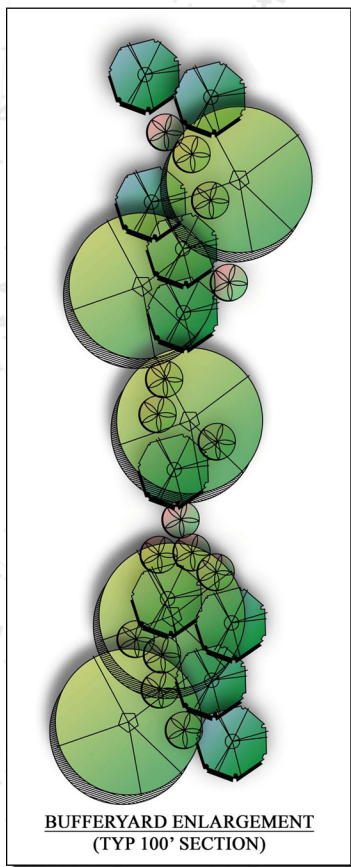

- PROJECT PHASING: TO MEET THE CLIENT'S BUDGETARY AND OPERATIONAL COST CONSTRAINTS, AS WELL AS ADHERE TO THE TOWN'S APPROVAL PLANNING PROCESS, RED SWING PURSUED A MULTI-PHASE PROJECT APPROVAL TO REMOVE THE NEED TO GO BACK FOR PLANNING REVIEW ON ADDITIONAL BUILDING EXPANSIONS.

PROJECT STAFF:

**MATTHEW SMITH, ROBERT MCCOLLIM,
ROBERT SMITH, C.K. MITCHELL**

REFERENCE:

**PIEPER O'BRIEN & HERR ARCHITECTS
(LOREN WRIGHT, AIA)**

PROJECT DATES:

FALL 2010 - PRESENT

4154 OLD WILLIAM PENN HIGHWAY, SUITE 300 • MURRYSVILLE, PA 15668

P: 724.325.1215 F: 866.295.5226

WWW.REDSWINGGROUP.COM

CIVIL ENGINEERING • DUE DILIGENCE • SUSTAINABLE & WATER • TELECOMMUNICATIONS • OWNERS