

# TYPHOON LIGHTING /AMD VENTURES

PITTSBURGH, PENNSYLVANIA



RED SWING GROUP WORKED WITH AMD VENTURES AND ITS ARCHITECT, DUNN AND ASSOCIATES, ON THE TYPHOON LIGHTING STORE EXPANSION AND RETAIL CENTER IN SWISSVALE, PA TO CREATE ADDITIONAL SQUARE FOOTAGE FOR SHOWROOM AND OFFICE SPACE AT THE LIGHTING RETAILER'S EXISTING SITE ON BRADDOCK AVENUE IN REGENT SQUARE. RED SWING'S SCOPE ITEMS INCLUDED:

- SITE DESIGN FOR THE 4,400-SQUARE-FOOT, TWO-STORY ADDITION.
- ZONING COORDINATION.
- SECURING A VARIANCE FOR REDESIGNED PARKING AREA.

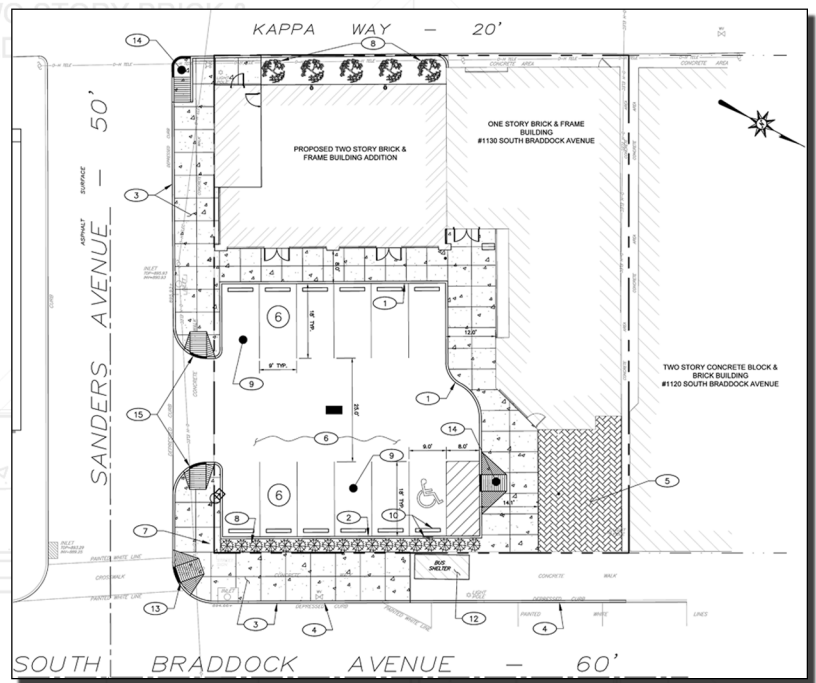

## SITE CHALLENGES:

- SMALL SITE: THE BUILDING ADDITION REQUIRED A REDUCTION AND RECONFIGURATION OF THE SITE'S EXISTING PARKING AREA.

## CLIENT:

**AMD VENTURES**

## ARCHITECT:

**DUNN AND ASSOCIATES**

## KEY PERSONNEL:

**MATTHEW SMITH, ROBERT MCCOLLIM**

## PROJECT DATES:

**JUNE 2010-AUGUST 2010**

**4154 OLD WILLIAM PENN HIGHWAY, SUITE 300 • MURRYSVILLE, PA 15668**

**P: 724.325.1215 F: 866.295.5226**

**WWW.REDSWINGGROUP.COM**

**CIVIL ENGINEERING • DUE DILIGENCE • SUSTAINABLE & WATER • TELECOMMUNICATIONS • OWNERS**